

# What Are Cable Lugs?

Standard Lugs are manufactured from seamless copper tube to BSEN 12449: 2016. All terminals are provided with an inspection hole to ensure the conductor is fully inserted before crimping. A bell mouth also ensures a smooth transition from lug to cable, thus avoiding the problems of chafing where the component is subject to vibration.

Narrow Palm lug are generally used when terminating cables into low voltage moulded case circuit breakers where limited width terminal blocks causes problems for standard lug terminals. The compressed palm of the narrow palm lug provides an effective and efficient termination.

Long Palm Lugs also known as Post Office 2-Hole lugs are used for terminating onto bus bar systems or extended take off palms on contactors, MCBs, ACBs or where more than one stud fixing is required.

Right Angle Lugs as used when more than one cable is to be terminated into the contact block or take off palm and the cables are coming from different directions, rather than trying to form or bend a traditional lug. Professionally formed at source, meeting all the relevant standards, takes all the hassles away.

Round Pin & Flat Blade Copper Tube Lugs are designed for terminating cables into terminal blocks. The reduced pin / blade makes these terminals ideal for terminating conductors into contact block applications.



Standard Lug



Narrow Palm



Long Palm



Right Angle



Pin & Flat Blade

## Cable Lug Types

One of the most important reasons for using the right cable lug is to ensure that the connection is strong and secure. A properly sized and installed cable lug should provide a mechanical connection that is able to withstand the electrical and mechanical forces applied to it, such as tension, compression, bending, and vibration. A weak or loose connection can cause problems such as electrical arcing, overheating, fire, and equipment failure.

Another reason for using the right cable lug is to ensure that the connection is electrically safe and compliant with relevant standards and regulations. A properly sized and installed cable lug should provide an electrical connection that is able to handle the current and voltage of the circuit, and that is resistant to electrical hazards such as short circuits, ground faults, and over-voltages. A poorly designed or installed cable lug can cause electrical accidents, such as shocks, fires, and equipment damage.

In addition to safety and reliability, using the right cable lug can also help improve the performance and efficiency of an electrical system. A properly sized and installed cable lug can help reduce resistance and voltage drop, which can improve the power and energy transfer of the circuit, and can reduce losses and waste. This can help save energy, reduce costs, and extend the life of electrical equipment.

Furthermore, using the right cable lug can also help avoid costly and time-consuming problems and repairs. A poorly designed or installed cable lug can cause problems that require expensive repairs or replacements, and that can disrupt the operation and productivity of an electrical system. By using the right cable lug, businesses and individuals can save money, reduce downtime, and prevent costly and frustrating problems.

Copper Butt Splices are designed for jointing low voltage conductors. These tube splices feature bell mouth entry at both ends to ease the insertion of the conductor and central stop to ensure correct positioning.



**Butt Splice**

Transformer Lugs are manufactured in accordance with E.A specification which means a 4 hole stud fixing arrangement for the connection of cables via copper lugs. Each stud hole will be 8mm in diameter. Sizes 95mm<sup>2</sup> to 300mm<sup>2</sup> are brazed palm type, 400mm<sup>2</sup> to 1000mm<sup>2</sup> are dimensionally the same as our standard lug with the exception of the palm fixing holes.

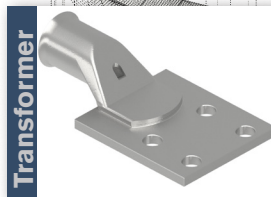

**Transformer**

Mechanical lugs are manufactured from HE 30 TF Aluminium alloy, they are designed to terminate Copper or Aluminium core power cables without the use of crimping tools. Mechanical lugs cover cable sector range 50 to 500mm<sup>2</sup> in just four sizes.



**Mechanical**

### Conclusion

In conclusion, using the right cable lug is essential for ensuring the safety, reliability, and performance of an electrical system. A properly sized and installed cable lug can provide a strong and secure connection, can prevent electrical hazards, can improve system performance and efficiency, and can avoid costly and time-consuming problems.

Therefore, it is important to carefully select and install the right cable lug for each application and circuit, and to follow the manufacturer's instructions and relevant standards and regulations.

